

FOR FURTHER INFORMATION,
 PLEASE CONTACT: RANDY GOODMAN
 at 216.381.8200
 or visit: www.goodmanrealestate.com

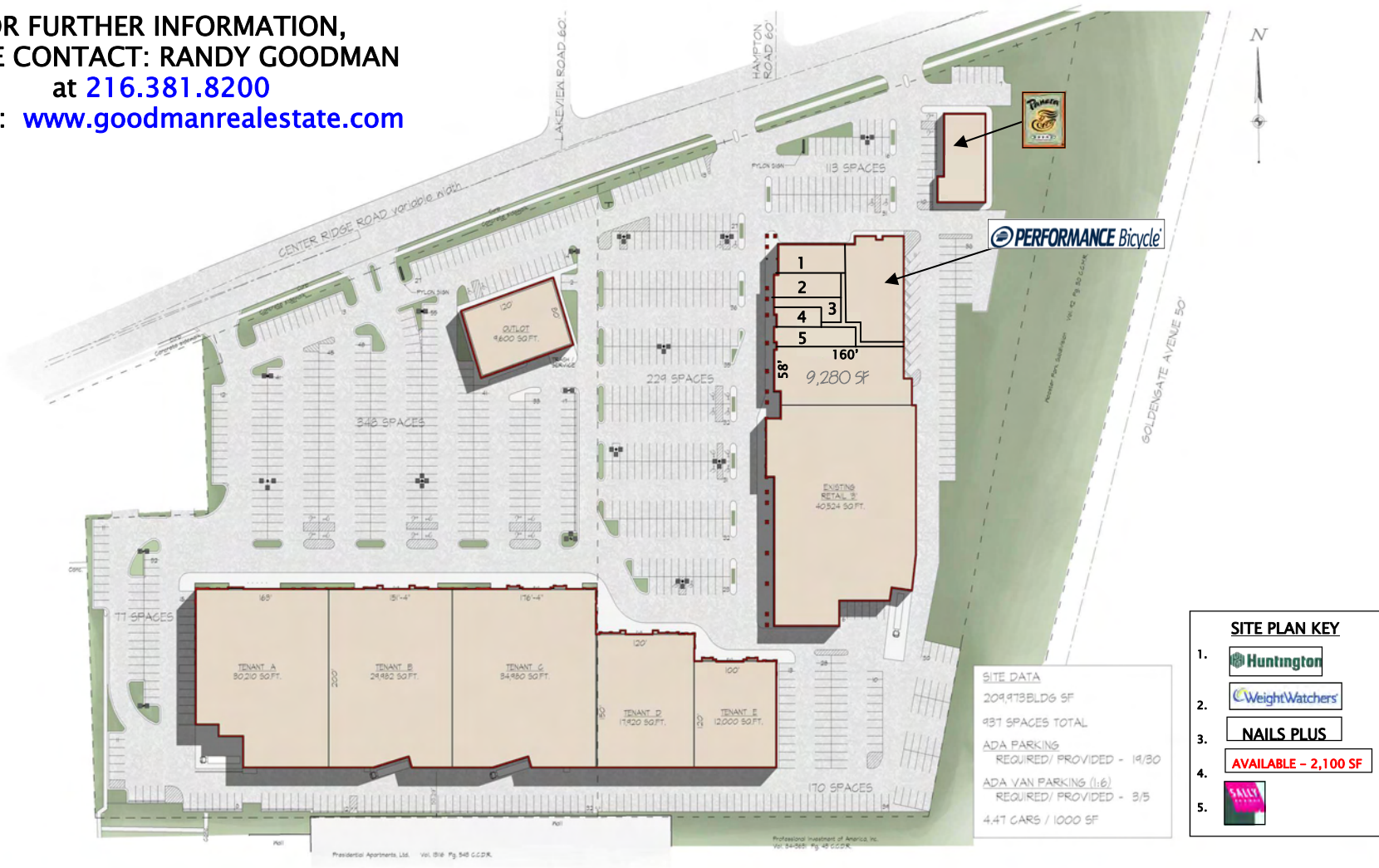

PERFORMANCE Bicycle

SITE DATA
 204,913 BLDG SF
 931 SPACES TOTAL
 ADA PARKING
 REQUIRED / PROVIDED - 19/30
 ADA VAN PARKING (1:6)
 REQUIRED / PROVIDED - 3/5
 4.4T CARS / 1000 SF

SITE PLAN KEY

1. **Huntington**
2. **WeightWatchers**
3. **NAILS PLUS**
4. **AVAILABLE - 2,100 SF**
5. **PINK**

ROCKPORT

Rocky River, Ohio | Retail Shopping Center | Wald & Fisher

